

CONFERENCE HANDBOOK

Methodist Conference 2015

Blenheim

Te Háhi Weteriana o Aotearoa

CONTENTS

Welcome to Conference 2015	Page 1
Where We Gather	Page 3
Powhiri: Welcome to Conference	Page 7
The Names of Those Who Have Died During the Year	Page 8
General Information	
<i>Introduction to Conference</i>	Page 9
<i>Directions to Venues</i>	Page 9
<i>Parking</i>	Page 9
<i>Registration/Information/Help Desk</i>	Page 10
<i>Conference Arrangements Committee</i>	Page 10
<i>Telephones and Fax</i>	Page 10
<i>Bank & Postal Facilities</i>	Page 11
<i>Meals</i>	Page 11
<i>Transport</i>	Page 11
<i>First Aid</i>	Page 11
<i>Medical Clinics & Pharmacy</i>	Page 11
<i>Fire and Emergency Procedures</i>	Page 12
<i>Other Enquiries</i>	Page 12
<i>The President & Vice-President</i>	Page 12
<i>Chaplains of Conference</i>	Page 12
<i>Conference Hosts</i>	Page 12
Additional Notes:	Page 12
- <i>Bring your walking shoes</i>	
- <i>Keep Cups</i>	
What Will Happen at Conference?	Page 13
Other Events During Conference	Page 15
Roles of People & Groups at Conference	Page 16
Conference Contact Numbers	Page 18
Location of the Conference Venues	Page 21

Banner design by Artist Janice Gill

WELCOME TO CONFERENCE 2015

Tena koutou katoa
Talofa lava
Mālō e lelei
Ni san bula vinaka

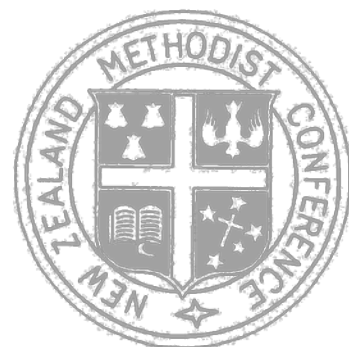

Greetings to you all

Welcome to the Methodist Church of New Zealand, Te Haahi Weteriana o Aotearoa 2015.

As a result of our visits around the connection this past year we have witnessed signs of growth in many places. For this Conference we extend our theme slightly to acknowledge and encompass many different directions of growth and especially growing for our next generations.

The theme therefore is:

“A time to re-sow, a time to re-grow”

Conference 2015 will be held in Blenheim at the Marlborough Convention Centre, 42A Alfred St, Blenheim.

Conference will begin with the Powhiri and Welcome on Saturday 14th November at 11.00am, followed by a short break. The Opening Worship and Service for a time of remembering and honouring those who have served the Connexion and who have died since Conference last year will follow at 12.00 noon.

Lunch for all will follow after the service. Families of the deceased will be hosted by President Tovia and Vice President Bella served in the Wesley Centre, all others will have lunch in the Marlborough Convention Centre.

At 2.30pm, in the Convention Centre, there will be a service for the Celebration of Life and Leadership of those Connexional appointments, presbyters and lay people who retire at this Conference and at 6.30pm a Conference Dinner will be held. The speaker at the dinner will be Sir Ray Avery - New Zealander of the Year 2010.

On Sunday morning at 9:30am we will all join together in morning worship prior to the Te Taha Maori and Tauivi meetings in the Blenheim Methodist Church, 3 Henry Street led by Rex Nathan and Setaita Kinahoi-Veikune.

Blenheim Methodist Parish will host worship for visitors not attending TTM/Tauwi meetings with St Andrews Presbyterian at St Andrews Church at 10:00am (*next door to the Wesley Centre (Blenheim Methodist Parish)*). The Union Parish of Picton will host worship in the Picton Church, 40 Broadway, Picton at 10:00am.

Te Taha Maori and Tauwi meetings follow morning worship at 10:00am, Te Taha Maori at the Wesley Centre (Blenheim Methodist Parish) in the Stubbs Lounge and Tauwi in the Auditorium. Lunch for Conference Representatives will be provided.

The Main worship event for the day will be the Ordination Service commencing at 1:30pm on Sunday afternoon at the Convention Centre followed by afternoon tea. The rest of the afternoon and evening is free time to further explore the Blenheim region.

Business sessions will take place from Monday 8:30am to Wednesday 1:00pm in the Convention Centre.

During the Conference we will welcome visitors and special guests on Tuesday evening from 7:00pm.

Each day will begin and close with worship. Monday -Trinity College, Tuesday – Wasewase Ko Viti Kei Rotuma, Wednesday – Vahefonua Tonga

Conference will conclude on Wednesday afternoon at 2:00pm with the Covenant Service at the Wesley Centre (Blenheim Methodist Parish).

This will be followed at 4pm with the induction of the Rev David Poultney as Superintendent of the Nelson, Marlborough, West Coast Synod. All Conference members who are able are invited to stay for this service.

It is our hope that this Conference will provide opportunities and challenges that will move us forward into the future, a future that embraces and celebrates our bicultural journey and the diversity that is Te Haahi Weteriana o Aotearoa, the Methodist Church of New Zealand.

May we continue to grow our faith, to grow our unique and individual gifts and to contribute to the growth and development of this, our Church here in Aotearoa.

Rev Tovia Aumua, President
Dr Arapera Ngaha, Vice-President

WHERE WE GATHER

The Nelson Marlborough West Coast District

Some Notes on our Story

The Nelson, Marlborough, West Coast District unites three distinct parts of the South Island and stretches from where we are in Marlborough westwards through Nelson and down along the West Coast. This is a physically large area but with a very small population; it is no surprise then that our people enjoy getting together and the life of our synod is marked by friendship, hospitality and a commitment to sharing our resources as best we can to promote learning, spirituality and building community.

As we prepared for Conference we realised we did not have a synod banner so we held a competition to create one. The winning design was by Janice Gill, a gifted artist and member of St John's in the City, Nelson. It has been crafted both as a poster in bright colours and in quilted fabric with a rich texture.

The banner symbolizes our region with bold design and colour, there is purple for our vineyards, black for our coal, yellow for sunshine and beaches. There are symbols of towering mountains, our local fisheries and the graceful Nikau. The banners will tour the synod going from place to place.

We would like to thank and acknowledge both Janice Gill and the team who created our fabric banner. Elizabeth Clark, Linda Grant and Margaret Patrick from St John's in the City and Bev Dyke from St Andrew's, Motueka.

A stole has also been supplied drawing on some of the same imagery which will be used in the induction of David Poultney as our new District Superintendent after Conference finishes.

Some notes about the West Coast and Nelson are included but we want to give primacy to our hosts in this place; the people of Marlborough.

We are grateful to Arthur Phillips for an essay on Maori history in Marlborough from which these notes on Marlborough are taken. The full essay can be accessed via the Nelson, Marlborough, West Coast pages on the MCNZ website.

The West Coast

The South Island's West Coast, often simply "The Coast" has been described as a 600 by 50km strip of rugged bush clad mountain and lush cultivated river valleys between the towering Southern Alps and the pounding surf of the Tasman Sea. We hold many of the most beautiful sights in New Zealand from glaciers to rainforests, glassy mountain lakes and mountain passes.

West Coasters are a unique people because we live in our own isolated area. Travelling in and out of the region has been difficult historically and even today driving through the mountain passes to the Coast adds a sense of excitement and discovery. Many of our most valuable resources are taken raw from this area. Our most valuable resource, our children, must often leave too to complete their education and it can be a challenge to encourage them to come home.

Our geographic size and diversity makes for a splendid isolation but brings its own difficulties. The distance from Karamea to Haast is the same as from Auckland to Wellington – but is a significantly more demanding drive. Our little towns and settlements are often some distance from each other and life on the Coast encourages both self reliance and cooperation with our neighbours; especially in the face of the challenges this region faces. You will all remember the Pike River disaster but other than this we are prone to earthquakes and extreme weather. Also our economy is challenged by the global slump in coal mining and by a lack of well paying jobs. Our church communities work alongside other Christians and other community groups to make life better in many ways up and down the Coast.

The Coast is our home, it has made us who we are and we encourage you to pay us a visit.

Nelson

The Nelson district is dominated by the City of Nelson but even here it is apparent that we are on the threshold of a wild and beautiful region.

Maori settlement in the Nelson area is well attested to by the thirteenth century and there is extensive evidence of widespread settlement in our fertile valleys with their mild climate.

This region proved as attractive to European settlement as it had to Maori. The Nelson area has an enviable lifestyle and attracts new residents from across New Zealand and from around the world. We are fortunate to have a vibrant artistic and cultural life which adds a richness and depth to life in the region.

Marlborough

Marlborough is the faultline meeting place of two tectonic plates. The Marlborough Sounds are sea-flooded river valleys. There is archaeological evidence of the Wairau Bar being a very early point of Maori settlement.

Captain Cook made his first Marlborough landfall at Ship Cove, made a base there and returned several times on his voyages.

Just as Marlborough had attracted Maori settlement, it attracted European sealers and whalers, before the arrival of the Methodists Rev Samuel Ironside and Sarah Ironside in 1840. Their activities and interactions and the subsequent history of Wairau Maori (and in particular Ngati Rarua) are outlined in Arthur Phillips' essay which is on the Conference website.

In the latter half of the 19th century a multitude of European Christian churches sprang up throughout the Sounds, Wairau Valley, the Awatere and Kaikoura coast, including Methodist congregations who often met in homesteads. The first Methodist church in Blenheim was built in 1865. (This was celebrated with wonderful 150th Anniversary activities in March this year).

For a hundred years the Methodists had many churches, many preachers, big congregations, huge Sunday School attendance. Older buildings were replaced with new buildings. Blenheim Parish hosted the 1984 Methodist Conference at its new (1983) Wesley Centre.

When church union was in the air, the Picton Methodists and Presbyterians formed a Union in 1971, and are still going strong in their modern 1987 building which boasts an excellent EQ resistance rating.

The late 1990s saw an unfortunate movement of Methodist members away to churches with more conservative theologies.

The Blenheim Parish established the successful John's Kitchen early in the 2000s. This still thrives independently under the Crossroads Trust.

In 2010 Blenheim Parish and Union Parish of Picton entered a Regional Shared Ministry agreement, and together appointed Rev Ian Boddy. Since he was a probationer, Rev Jill van de Geer became Superintendent Minister and Synod's role became more recognised. Blenheim Parish is now more Connexional in its outlook, and has been asked to host Conference this year.

Maori and the Methodist Church in Port Underwood and Te Tau Ihu O Te Waka A Maui (top of the South Island) since 1840

In 1838 the Reverend Samuel Ironside, having completed his training at Wesley Theological College in Hoston England, was sent to the Hokianga in New Zealand to begin life as a missionary arriving there in 1839 accompanied by his young bride Sarah. It was there he learned and became reasonably fluent in te Reo Maori and was able to converse with the local iwi and read from the Maori Bible that had been produced.

After witnessing the signing of the Treaty of Waitangi, Samuel and Sarah later moved to Port Underwood again working amongst the Maori people laying the foundation for the Wesleyan Church in Nelson and Marlborough.

The Reverend Ironside befriended and lived amongst the people from the local iwi building a relationship learning their traditions and customs.

He was instrumental in converting many Maori to Methodism and opened the doorway to other Methodists to the Wairau, e.g. "The Seamer Methodist Mission".

Today there are only a few Maori Methodists left in the Wairau, but when those that live away are required, they return home to support those who keep the fires burning and to remember what the Rev Ironside had started in 1840.

POWHIRI: WELCOME TO CONFERENCE

The Powhiri (Welcome) to Conference will be held at Marlborough Convention Centre, 42A Alfred St, commencing at 11:00am on Saturday 14 November 2015.

The powhiri is the formal process of recognising and acknowledging the coming together of two peoples, those of the place of gathering and those from elsewhere. The powhiri is a process that allows us to acknowledge and mourn our dead together, to honour each other, to celebrate and share in a communal and family way. We have adapted this process to reflect the bicultural nature of our church and our deeply rooted sense of social justice as we begin our Methodist Conference each year. It belongs to all of us.

Our hosts this year are the Nelson, Marlborough, West Coast Synod.

Members of Conference and guests (manuhiri) will wait in the carpark. The karanga (welcoming call) will be the signal to proceed led by Te Taha Māori, the Presidential team and the families of the deceased.

Families of the deceased will wait in the foyer.

The speakers for the manuhiri will take the front row of seats, the families of the deceased will take up the next few rows and all other conference members will enter and take up seats throughout the venue.

Speeches of greetings and acknowledgements will then commence.

The Presidential lunch for the families of the deceased will be served in the Wesley Centre, 3 Henry St after the service. Lunch for everyone else will be at the Convention Centre.

Please note: No photography is allowed during the Powhiri or other Conference services except by the official photographer. Mobile phones should be switched off.

Tovia Aumua – President

Arapera Ngaha – Vice President

Diana Tana – Tumuaki, Te Taha Maori

THE NAMES OF THOSE WHO HAVE DIED DURING THE YEAR

Ralph John Ballinger

Anthony (Tony) Dale

Richard Brian Glover

Graham Earl Hawkey

John Sedgley Hickman QSO

Lana Lazarus

Harry Lendrum

Stuart John McCallum

Jean Isobel McInnes MBE

Alan Newman

Rosaline Mary Vingoe Pearcy (Vin)

Russell Clifton Pitt

Jean Rickard

Edith Sealey

Lane Tauroa

Basil Clifford Teague

Neville Thornicroft

Kristofer Ngahau Exham Rere Wichman

Jack Wright

Lourdino Yuzon

We carry their memories with us into the Powhiri
and on into the life of Conference

GENERAL INFORMATION

Introduction to Conference

For those people who are attending Conference for the first time, there will be an 'Introduction to Conference' session which will explain how Conference works. This will be held in the Blenheim Methodist Church at the Wesley Centre, 3 Henry St, 9:30am - 10:30am on Saturday 14 November.

Directions to Venues

Marlborough Convention Centre

See maps on pages 21-24

42A Alfred St, Blenheim 7201

T: 03 579 5047

Wesley Centre (Blenheim Methodist Parish)

See maps on pages 21-24

Address: 3 Henry St, Blenheim, 7201

T: 03 578 5796

Note: a map of Blenheim will also be included in your Conference pack.

Parking

There is very limited street parking in the area but there is a car park building across the road from the Marlborough Convention Centre.

The tariff is \$1.00 per hour, 9:00am - 5.30pm, Monday - Friday. Pay on exit, no restrictions.

There is also Early Bird or All Day parking @ \$4.00. In by 9:00am and out after 4:00pm, Monday - Friday.

Saturday afternoon, Sundays and evenings free.

NOTE: If you have a disability or are transporting someone with a disability please let us the people at the Help Desk know.

Registration/Information/Help Desk Locations & Times

Friday 13 November:

Wesley Centre (Blenheim Methodist Parish), 3 Henry St, Blenheim
8:30am – 5:30pm

Saturday 14 November:

Marlborough Convention Centre, 42A Alfred St, Blenheim 7201
9:00am – 10:45am and 1:00pm – 4:15pm

Monday 16 November – Wednesday 18 November:

Marlborough Convention Centre
8:30am – 6:00pm Monday & Tuesday
8:30am – 1:00pm Wednesday

Your **NAME TAG** and **CONFERENCE BAG** will be available for you to collect during those times.

This desk will be staffed throughout Conference commencing on the morning of Friday 13 November, 2015.

Conference Arrangements Committee

On behalf of the Arrangements Committee and the Nelson, Marlborough, West Coast Synod, Welcome to Conference 2015! We hope that your stay in Blenheim is an enjoyable one. For all enquiries please contact the **Registration/ Information/ Help desk**.

Telephones and Fax

For urgent contact other than your personal cell phones, please ask people to use the following numbers:

Jill van de Geer, Convenor, Conference Arrangements Committee:
T: 027 467 0077

Rev Ian Boddy, Committee Member (Parish Superintendent):
T: 021 109 0454

Jean Faithful, Committee Member:
T: 027 686 7700

Frances Litchfield, Committee Member:
T: 021 052 6941

Bank & Postal Facilities

The Post Office is on the corner of Main St and Scott St, the closest Bank is ANZ in Market St. Other major banks are also available in the same vicinity. If you require these services please enquire at the **Registration/Information/Help Desk**.

Meals

Lunch on Monday 16th will be in the Foundry at the Wesley Centre. On Tuesday 17th and Wednesday 18th you will be given \$10 per day for purchasing your own lunch in the City centre or at the upstairs club dining room in the Convention Centre where a meal can be purchased. The Convention Centre is adjacent to the Town Centre so the nearest café is a 2 minute walk away.

Dinner on Monday 16th and Tuesday 17th will be at the Convention Centre. Morning and afternoon teas will be in the Foundry at the Wesley Centre.

Conference Dinner on Saturday night will be in the Marlborough Convention Centre. Note that this is not included in the Conference fee and must be booked separately on your registration form, or by emailing wendyk@methodist.org.nz no later than 5 November 2015.

Transport

If you have any transport requirements, please contact the Registration/Information/Help Desk. There will be transport at all breaks to transport any people unable to walk to the Wesley Centre. Please register your name at the Help Desk so that a driver can be provided for you.

First Aid

If you require immediate first aid assistance or treatment please see the Registration/Information/Help Desk volunteers.

Medical Clinics, Pharmacy and After Hours Medical Centre

Wairau Hospital, Hospital Rd, Blenheim
T: 03 520 9999

Life Pharmacy
101a Market Street Blenheim
T 03-578 5228

Fire and Emergency Procedures

In the event of an emergency, please follow the instructions given by the Marlborough Convention Centre Staff. Gathering places will be indicated by them.

Other Enquiries

All enquiries other than stated above, please contact the **Registration/Information/Help Desk**.

The President & Vice-President

Those who would like to see Tovia Aumua or Bella Ngaha during Conference should make arrangements through the Chaplains, JooHong Kim and Nicola Grundy. Their office will be at the Wesley Centre (Blenheim Methodist Parish).

Chaplains of Conference

JooHong Kim and Nicola Grundy are the Conference Chaplains. JooHong and Nicola are also available as Chaplains to members of Conference during Conference.

Conference Hosts

Thelma Efford and Motekiai Fakatou are the Conference Hosts. They will be looking after the wellbeing of official visitors, and representatives from other Churches and agencies.

Additional Notes

Bring Your Walking Shoes

It is a very pleasant 5 minute walk between the Wesley Centre (Blenheim Methodist Parish) and the Marlborough Convention Centre. Morning and afternoon teas will be at the Wesley Centre. Transport will be available for any who require it.

Keep Cups

If you were a member of Conference 2014 you will have received a "Keep Cup". Please bring it back to use it again. It will make life easier for all and is good for the environment.

A Reminder

***Both venues are smoke-free and
the Conference Dinner is alcohol free***

WHAT WILL HAPPEN AT CONFERENCE?

Conference Day to Day

Blenheim

Venue Locations

Marlborough Convention Centre: Alfred Street, Blenheim

Wesley Centre (Blenheim Methodist Parish): 3 Henry Street, Blenheim

Friday 13 November – Wesley Centre (Blenheim Methodist Parish): 3 Henry Street

8:30am – 5:30pm	Registration open in foyer at the Wesley Centre (Blenheim Methodist Parish)
10:00am	Stationing Committee (<i>Stubbs Lounge, Wesley Centre, 3 Henry Street</i>)
1:00pm	Lunch
2:00pm – 5:00pm	Tauiwi Strategy (<i>Stubbs Lounge, Wesley Centre, 3 Henry Street</i>)
2:00pm – 5:00pm	Te Taha Maori (<i>Lounge 2, Wesley Centre, 3 Henry Street</i>)
5:30pm	Wesley Historical Society AGM/Dinner (\$35 Incl. GST) (<i>Wesley Centre, 3 Henry Street</i>)

Saturday 14 November – Marlborough Convention Centre: Alfred Street (unless otherwise stated)

	Registration open 9:00am to 10:45am & 1:00pm to 4:15pm at Convention Centre
8:30am – 9:30am	Evangelical Network Breakfast (<i>Foundry, Wesley Centre, 3 Henry Street</i>)
9:30am	Introduction to Conference (<i>Auditorium, Wesley Centre, 3 Henry Street</i>)
10:45am	<i>Families of the Deceased meet with Tumuaki (Foyer of Convention Centre)</i>
11:00am	Powhiri / Welcome – Please wait in the car park to be called in.
12:00 noon	Service to Honour Those Who Have Died (<i>Whole Conference</i>)
1:00pm	Lunch-for all attendees - Convention Centre
1:00pm	Presidential Lunch with Families of the Deceased (<i>Wesley Centre, 3 Henry Street h</i>)
2:30pm	Recognition of Retirees / End of Ministries
4:15pm	Ordination Service Practice
4:15pm	Free time
6:30pm – 10:00pm	Conference Dinner – (<i>registration required – \$60 incl. GST</i>) With guest speaker Sir Ray Avery - New Zealander of the Year 2010

Sunday 15 November – Marlborough Convention Centre: Alfred Street (unless otherwise stated)

9:30am	Sunday Worship – <i>Wesley Centre, 3 Henry Street</i>
10:00am	Te Taha Maori & Tauiwi Meetings – <i>Wesley Centre, 3 Henry Street</i>
12:00 noon	Lunch (for Conference Representatives only) (<i>Foundry, Wesley Centre, 3 Henry Street</i>)
12:00 noon	Lay Preachers meeting and meal (<i>Stubbs Lounge, Wesley Centre, 3 Henry Street</i>) (<i>registration required – no cost</i>)
1:30pm	Ordination Service
3:30-pm	Afternoon Tea (Wesley Centre, 3 Henry Street)
4:00pm	Free time and own arrangements for Dinner
6:00pm	Liberal Society / Evangelical Network Meeting/Dinner, <i>Raupo Riverside Café, 6 Symons Street, Blenheim.</i> (<i>registration required - (\$25 incl. GST)</i>)
7:00pm	Gay, Lesbian, Bisexual and Transgender Network and Friends Dinner (<i>all are welcome</i>), <i>Raupo Riverside Café, 6 Symons Street, Blenheim - \$55 incl. GST</i> RSVP David Poultney davidcpoultney@gmail.com or (03) 545 7181

<i>Monday 16 November - Marlborough Convention Centre: Alfred Street (unless otherwise stated)</i>	
8:30am	Opening Worship: Trinity College
9:00am	Bible Study Rev Dr Nasili Vaku'uta
9:10am	- Introduction to Conference Staff, Observers, Visitors, Council of Elders - Consensus Decision Making – reminder of Conference Process - Questions 1-24
9:40am	Te Taha Maori and Tauwi Caucus's
10:30am	<i>Morning Tea (Foundry, Wesley Centre, 3 Henry Street)</i>
11:05am	Business Committees – choose one committee
12:15pm	<i>Lunch (Foundry, Wesley Centre, 3 Henry Street)</i>
1:15pm	Partnership Reporting, Council of Conference, Te Taha Maori, Tauwi
2:45pm	Board of Administration
3:30pm	<i>Afternoon Tea (Foundry, Wesley Centre, 3 Henry Street)</i>
4:00pm	Board of Administration (<i>cont'd</i>)
4:50pm	Bible Study Rev Dr Nasili Vaku'uta
5:00pm	Trinity College
6:00pm	<i>Evening Meal</i>
7:00pm	Korean Churches presentation
7:20pm	Bio Ethics Roadshow 'FORGED'
8:45pm	Close of Day: Nelson – Marlborough – West Coast Synod

<i>Tuesday 17 November - Marlborough Convention Centre: Alfred Street (unless otherwise stated)</i>	
8:30am	Opening Worship: Wasewase ko Viti Kei Rotuma
9:00am	Mission Resourcing
10:30am	<i>Morning Tea (Foundry, Wesley Centre, 3 Henry Street)</i>
11:05am	Bible Study: Rev Dr Nasili Vaku'uta
11:15am	Methodist Mission Aotearoa / Social Services
12:20pm	<i>Lunch – own arrangements on the town</i>
1:15pm	<i>Lunch-time Communion – Auditorium, Wesley Centre, 3 Henry Street</i>
2:00pm	Mission and Ecumenical
2:50pm	Bible Study: Rev Dr Nasili Vaku'uta
3:00pm	Communications
3:30pm	<i>Afternoon Tea (Foundry, Wesley Centre, 3 Henry Street)</i>
4:00pm	Social Issues (Public Issues Network)
5:00pm	Faith and Order
6:00pm	<i>Evening Meal</i>
7:00pm	Overseas Guests
7:30pm	Presentation on Health and Safety
8:45pm	Close of Day: Methodist Women's Fellowship

<i>Wednesday 18 November - Marlborough Convention Centre: Alfred Street (unless otherwise stated)</i>	
8:30am	Opening Worship: Vahefonua Tonga
9:00am	Law Revision
9:30am	Unfinished Business
10:00am	<i>Morning Tea (Foundry, Wesley Centre, 3 Henry Street)</i>
10:30am	Unfinished Business
1:00pm	<i>Lunch – own arrangements on the town</i>
2:00pm	Covenant Service (<i>Auditorium, Wesley Centre, 3 Henry Street</i>)
3:00pm	Close of Conference – Afternoon Tea available for any who need it.
4:00pm	Induction of David Poultney as Synod Superintendent (<i>Wesley Centre, 3 Henry Street</i>)
6:00pm	Synod Dinner at Foundry. RSVP to Jean Faithful jeanfaithful@xtra.co.nz before 12 th Nov.

OTHER EVENTS DURING CONFERENCE

Conference is an opportunity for a number of Methodist groups to host special purpose gatherings. Full details have been publicised by the groups concerned and in some cases advance notice is required for catering purposes.

Stationing / Tauwiwi Strategy

Friday 13 November, 10:00am, Wesley Centre, 3 Henry Street.

Wesley Historical Society AGM and Dinner

Friday 13 November, 5:30pm AGM, 6:30pm Dinner, The Foundry, Wesley Centre, 3 Henry St, Blenheim.

WHS Annual Lecture at 7:30pm: Everyone is warmly invited to hear Dr Garth Cant's presentation on: "The Methodist and Ratana Connections: Arthur Seamer and Wiremu and Urumanao Ratana"

The Evangelical Network Breakfast

Saturday 14 November, 8:30am, Wesley Centre, 3 Henry St, all are welcome.

Introduction to Conference

Saturday 14 November, 9:30am, in the Church, Wesley Centre, 3 Henry St, Blenheim.

Conference Dinner

Saturday 14 November, 6:30pm, Marlborough Convention Centre, 42A Alfred St, Blenheim (*tickets required - must be booked by 5th November, tickets \$60 incl. GST*).

Lay Preachers AGM and Lunch

Sunday 15 November, 12:00pm, Wesley Centre, 3 Henry St, Blenheim. (*booking required for meal if not registered for Conference, no cost*).

The Evangelical Network & the Liberal Society Dinner

Sunday 16 November, 6.00pm, Raupo Riverside Cafe, 6 Symonds Street, Blenheim (*booking required \$25 incl. GST*).

Gay, Lesbian, Bisexual and Transgender Network and Their Friends Dinner

Sunday 16 November, 7.00pm, Raupo Riverside Cafe, 6 Symonds Street, Blenheim (*registration required \$55.00 incl. GST*).
RSVP: davidcpoultney@gmail.com (*all are welcome*).

ROLES OF PEOPLE & GROUPS AT CONFERENCE

President

Rev Tovia Aumua fills an important pastoral role in the life of Conference and beyond. He shares leadership with the Vice-President and brings a sacramental ministry to the Conference.

Vice-President

Mrs Arapera (Bella) Ngaha shares with the President in the leadership role of Conference, and brings a pastoral concern, as well as sharing in the leadership team.

Tumuaki

Rev Diana Tana fills this position and provides leadership for Te Taha Maori.

General Secretary

The General Secretary, Rev David Bush, acts as the Secretary of Conference and has responsibility for the ordering of the Theology at Work (Business) Sessions of Conference. He is responsible for seeing that the reports are collated and that the business of Conference is dealt with.

Council of Elders

Present at Conference will be members of the Council of Elders. The Council consists of four people, two representing Te Taha Maori and two representing the Tauwi part of the Church (i.e. Pakeha, Pacific Island, African, Asian etc).

Their responsibilities include observing the way things are said and decided at Conference, against the background of the Church's bi-cultural journey. They may take opportunities to comment on what they see happening, and may intervene if they believe something taking place is contrary to the Church's bi-cultural commitment.

When a member of the Council speaks in Conference it is on behalf of the whole Council and after consultation with **all** Elders. The Council seeks to model an equal partnership, with half the Elders representing Te Taha Maori and half Tauwi (the rest of the Church), and makes its decisions through consensus.

Legal Advisor

Ruby Manukia- Schaumkel is appointed by the Conference and attends the Conference to ensure that the finer details of Church Law are adhered to. Presently the Legal Adviser checks all decisions that come to Conference, so as to ensure that the decision can be understood at a later date.

Te Taha Maori & Tauwi

Are the partners who make up the life of Conference. Te Taha Maori are Tangata Whenua (the people who are of the land). Tauwi is the name used within The Methodist Church of New Zealand/Te Hahi Weteriana o Aotearoa to describe the people who have come later to settle here from Europe, Asia, the Pacific, Africa, and other places.

Council of Conference

Conference has appointed a Council of Conference made up of 23 members. Ten members are nominated by Te Taha Maori and ten members nominated by Tauwi. The President, Vice-President and General Secretary are members and act as resource people. The work of the Council is focused on vision, policy and monitoring processes for the Church, rather than decision-making.

Wasewase ko viti kei Rotuma e Niu Siladi

The Fijian Synod of the Methodist Church.

Vahefonua Tonga 'o Aotearoa

Vahefonua is the Tongan Synod of the Methodist Church which meets during the year to make decisions relating to the life and work of Tongan Congregations.

Sinoti Samoa

The Samoan Synod meets through the year and makes decisions relating to the Samoan section of the Church. It reports to Conference.

Boards & Standing Committees

The Conference has a number of Standing Committees that meet throughout the year. Each carries out tasks asked of them by Conference and reports to the Conference. The Committees relate to matters such as Ministry, Faith and Order, Mission and Ecumenical and Social Issues.

Youth Delegation

The Conference has determined that there will be a youth delegation of 10 present at Conference. In addition, individual parishes may choose to nominate a youth person to represent them. The Youth Delegation tends to sit together in order to caucus as youth and sometimes comment to Conference as youth.

CONFERENCE CONTACT NUMBERS

The names and phone numbers listed here are for the information of Conference members and Conference staff only. They are based on information supplied on your registration form. The list is complete up to registrations as at 13 October 2015.

Aisea Laukau	0223026614	David Poultney	0223502263
Aisea Manu Naeata	02102321453	Diana Tana	0274431340
Akanesi Havea		Diane Brockbank	0278391181
Alamaine McGregor	02102724599	Dianne Claughton	0272997771
Alan Webster	0212640113	Doreen Wilson	0224567920
Ali'itasi Aoina-Salesa	0274971952	Doug Graham	0211647732
'Alipate 'Uhila	0272179053	Edwin Talakai	0276767053
Alisa Lasi	0211181774	Elenoa Paea	
Alison Ranui	0273888555	'Epeli Taungapeau	
Alivereti Uludole	0211437974	Fa'apaiaga Ieli	0211654658
Alofa Asiata	0272106328	Faatoafe Faleatua	
Amos Muzondiwa	0210745706	Faleatua	0210695777
Ana Fonua	0296500791	Faiva Alaelua	0210507949
Ana Teu Fonongaloa	02108680467	Falaniko Mann-Taito	0212653586
Andrew Doubleday	0273249540	Falanisesi Hafoka	
Andrew Gamman	0211682808	Fane Tuihaangana	0276226234
Angela Graham	0276601611	Fatuatia Tufuga	0272101394
Anne Peri	0210619045	Fay Richardson	0272895489
Anne Preston	0210341394	Fekita Halaleva	
Annette Mudford		Feleti Vaitohi	0273796614
Arapera Ngaha	0274209945	Fenuki Ha'unga	
Arthur Davis	021707046	Fifita Pani	0211122323
Aso Samoa Saleupolu	021570384	Filimone Kini Mapuhola	0276767053
Aufata Aufata	021784096	Finau Halaleva	
Augusten Subhan	0226527946	Fisi'ihoi Mone	0276767053
Barbara Peddie	02102431577	Foatea Tu'ipulotu	0212366888
Barbara Watson	0279524281	Folau Sinamoni	
Bertie Meyer	0210430961	Frances Rakena	0212536898
Beverley Fergus	0276205890	Freddy De Alwis	0221588661
Bill Peddie	0211339105	Fumi Schaaf	
Bob Franklyn	0212628275	Gillian Laird	02108339847
Cherryl Brown	0278438433	Glenys Webster	0272913878
Chris Johnston	021845832	Gloria Zanders	0212135670
Christine Baker	02108435932	Goll Fan Manukia	021451557
Christine Keesing	0211445939	Greg Wright	021337890
Christine Peak	0211320926	Havila Taukolo	0276767053
Clive Smith	021654250	Heather Power	0273586748
Cornelia Grant	0274692948	Helen McMillan	0273076961
Dale Peach	0274362698	Henry Hoglund	0211126645
David Bush	021392500	Hepisipa Havea	0212663422
David Hanna	021403377	Hilita Tupou	027481724
David McGeorge	021002891213	Hiueni Nuku	0272291381

Holakitu'akolo Paea		Lynne Frith	021659112
Hosea Tupou	021492409	Lynne Scott	
Iakopo Faafuata	021971012	Mafua Lolohea	0212730695
Ian Boddy	0211090454	Maika Kinahoi Veikune	
Ian Croft	0275052798	Maikali Bulicakau	0211796248
Ian Faulkner	021426747	Malu Vea	02111570475
Ian Harris	0272333436	Manoa Havea	0279714378
Ieremia Amani		Marama Hotere	0224683730
Amituana'i	0273780206	Margaret Birtles	0212606504
Ika Vea	02779484061	Margaret Inglis	0272670471
Ikaini Fonua	0297715300	Marilyn Welch	0272870757
Ikuvalu Havea		Marion Hines	0210532053
Ilaitia Tuwere	0211794915	Mark Gibson	0212155450
Jackie McGeorge	0272235915	Martin Oh	0272881938
Jan Tasker	0273208182	Mary Caygill	0272518611
Jan Fogg	0210606970	Matafonua Langi	02102217086
Jill van de Geer	0274670077	Matai'a Anita	
Jill White	0211398612	Lealaiauloto Falefitu	0210507949
Joeli Ducivaki	0274661036	Mataiva Dorothy	
John Murray	0275777821	Robertson	021 053 4894
Jonacani Vuidravuwalu	0211867204	Matt Roberts	
JooHong Kim	0276309026	Mele Kulutuma Tafuna	0276767053
Judith Symington	0211392805	Meleane Nacagilevu	0211716094
Julie Pearse	0212794280	Meleane Vakalahi	02108681352
Julie-Anne Barney-		Melema'u Molitika	0212623826
Katene	0275265968	Merrett Smith	0272662776
Kalo Kaisa	0278629454	Metuisela Tafuna	0212173094
Kalolo Akoteu	0274433596	Michael Lemanu	0210791593
Kalolo Fihaki		Minoneti Vehikite	0276767053
Kamipeli Tu'itahi	0276767053	Misilei Misilei	02102714099
Kathryn Walters	0211563028	Moi Kaufononga	0272907297
Keita Hotere	0223617447	Molia Tu'itupou	
Kepu Moa	0210504112	Montana Smalley	0273017274
Kuli Fisi'iahi	0275020507	Moses Manukia	
Laulelei Tu'ipulotu	0276767053	Mote Pahulu	0276767053
Laura Black	0274664600	Motekiai Fakatou	0272955012
Leotele Aumua	0210710638	Muaimalae Te'o	0278507342
Leumalealofa (Uma)		Myra Tautau	0272046964
Leao	0277177628	Naita Manu	0276767053
Lewin Tupou	02108733539	Nehilofi 'E-Moala-	
Limu Isaia	02040147888	'Aholelei	
Loli Kuresa		Neti Petaia	0279372063
Lotomo'ua Moli	0212018586	Ngaire Southon	02102245165
Lovely Vaipulu	02108379143	Nicola Grundy	0212741957
Loviana Lusaipau	0210638736	Oka Ieti	0211654098
Lupe Kalapa	0276767053	Opeti Prescott	0276767053
Lute Tu'uhoko		Osaiasi Kupu	0211410534
Lyn Heine	0212598150	Paea Tu'itupou	
Lynley Tai	0212648350	Pam Davis	021707046

Patricia White	021995770	Siosifa Mo'oni Tupou	0276767053
Paul Titus	021655092	Sireli Kini	021931461
Paula Taumoepeau	0274315460	Siutaisa Tukutau	
Pauli Ma'afu		Soane Vaipulu	02108379143
Pauliasi Alofi	0274106759	Steve Hargreaves	027371842
Pauline McKay	0212901225	Suiva'aia Te'o	0276841573
Pauline Taufu		Sulieti Poloniati	02102503694
Paulo Ieli	0211654658	Suresh Chandra	0273462747
Peni Tikoinaka	02102249024	Susan Thompson	0210570913
Peter Norman	0273787042	Taina Tupou	021334557
Peter Taylor	02040799607	Tali ki Vaha Latu'ila	0272574993
Peter van Hout	021977230	Talia'uli Tapa	0276767053
Peter Williamson	0211339105	Tangimausia Havili	0276767053
Philomeno Kinera		Tangitangi Manukia	
Pole Tu'uhoko		Tania Shackleton	0226857688
Prince Devanandan	0211686279	Tau Lasi	0211863342
Rachael Masterton	0272373180	Tavake Manu	0272498967
Raymond Mudford	021987606	Te Aroha Rountree	0275353521
Rex Nathan	0274744750	Terry Wall	
Roger Biddle	021377592	Tevita Tu'ipulotu	0276767053
Ron Malpass	027 667 0760	Tevita Finau	0211501970
Rosa Faafuata	021971012	Tevita Taufalele	0272498221
Rosalie Gwilliam	021 2133601	Tevita Tuki Fungalei	0276767053
Rowan Smiley	0274577618	Thelma Efford	0272951834
Roz Wilkie	0274481814	Tisileli Taufu	0212741957
Ruby Manukia-		Tofinuu Tuia	0221360805
Schaumkel	021819297	Tony Franklin-Ross	021481816
Rupeni Delai	0211783366	Tovia Aumua	021071 0638
Saane Langi	0210779077	Trevor Hoggard	021570385
Saia Havili	0276767053	Tu'ineau Talia'uli	0212573097
Saikolone Taufu	02102688103	Tu'ipulotu Finau	0211716923
Seini Tupou	0276767053	Tumema Faioso	0211438750
Seluvaia Nuku	0272291381	Tupa'i Williams	
Semisi Mantis		Unaisi Tikoinaka	021440812
Tapueluelu	0276767053	Utumau'u Pupulu	021842883
Sesipa Mausia	021345966	Vaikoloa Kilikiti	02102643050
Setaita Kinahoi Veikune	021570384	Vaiolupe Talakai	021865044
Sharon Tito	0275249841	Vaituulala Ngahe	0273206841
Shirley Rivers	0276522323	Vakasa Maea	0276767053
Siaosi Tu'ifua	0276767053	Val Meki	0272714739
Simote Taunga	0210333385	Valerie Marshall	0272735475
Sione Lea'aetua	0211752336	Viliani Finau	0211716923
Sione Felonitesi		Viv Whimster	0211372349
Manukia	0215329156	Waitemata Paongo	0276767053
Sione Kapeli Kalapa	0211537806	Wendy Keir	0272228878
Sione Tokaanauto			
Taukolo	0276767053		
Siosifa Pole	0272412926		
Siosifa 'Aholelei			

LOCATION OF CONFERENCE VENUES

Blenheim CBD Map

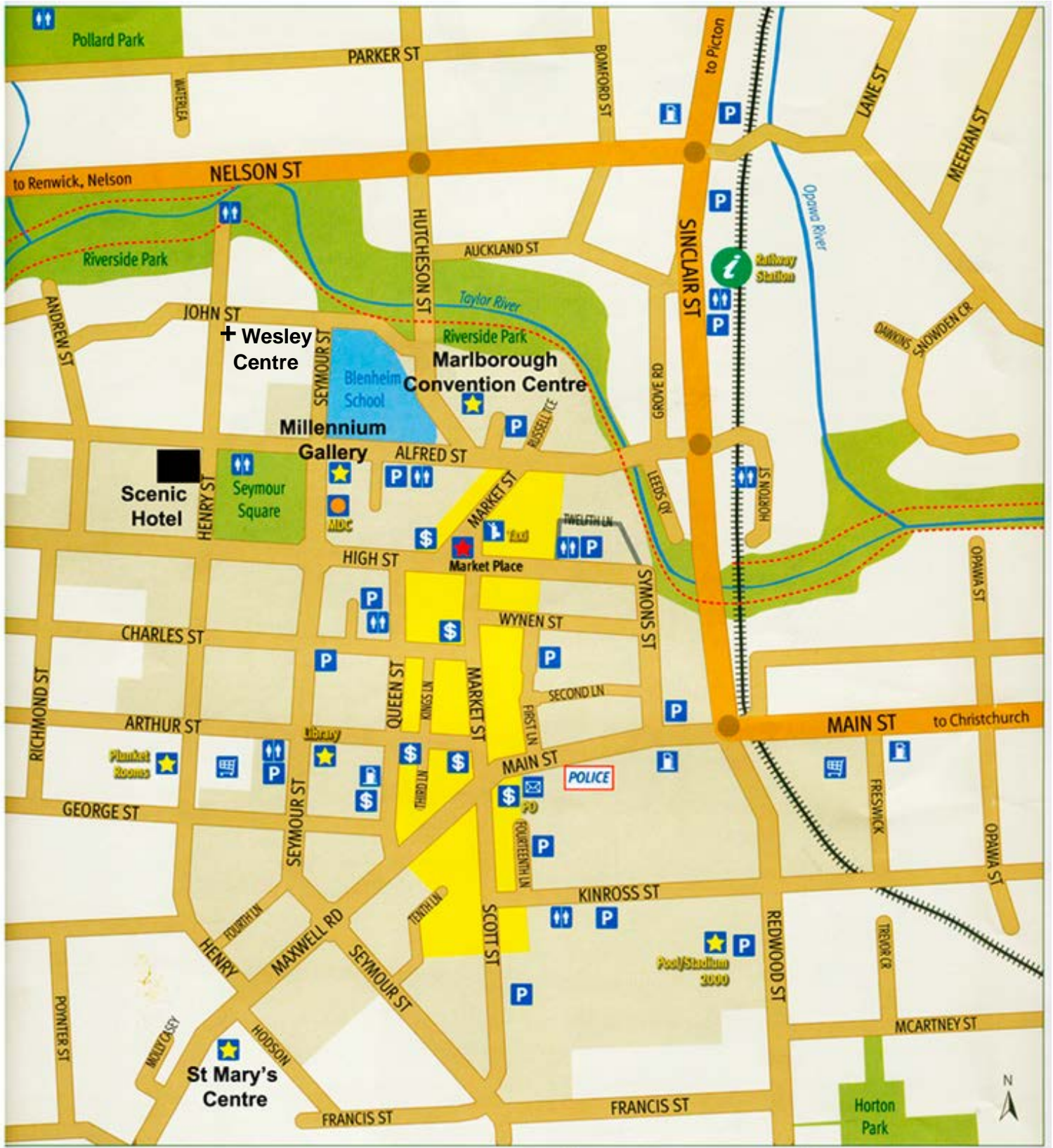

Airport

10 km from Blenheim. Taxi and shuttle services available.

Ferry

Interislander ferry terminal at Picton is 28km from Blenheim, and a 30 min taxi ride. Buses meet most ferry arrivals. Phone Picton i-site 03 5203113 or Blenheim Freephone 0800777181 for timetables

Wesley Centre (Blenheim Methodist Parish)

Rooms for Committee Meetings (Monday)

- Auditorium
- Stubbs Lounge
- Lounge 2
- Room C

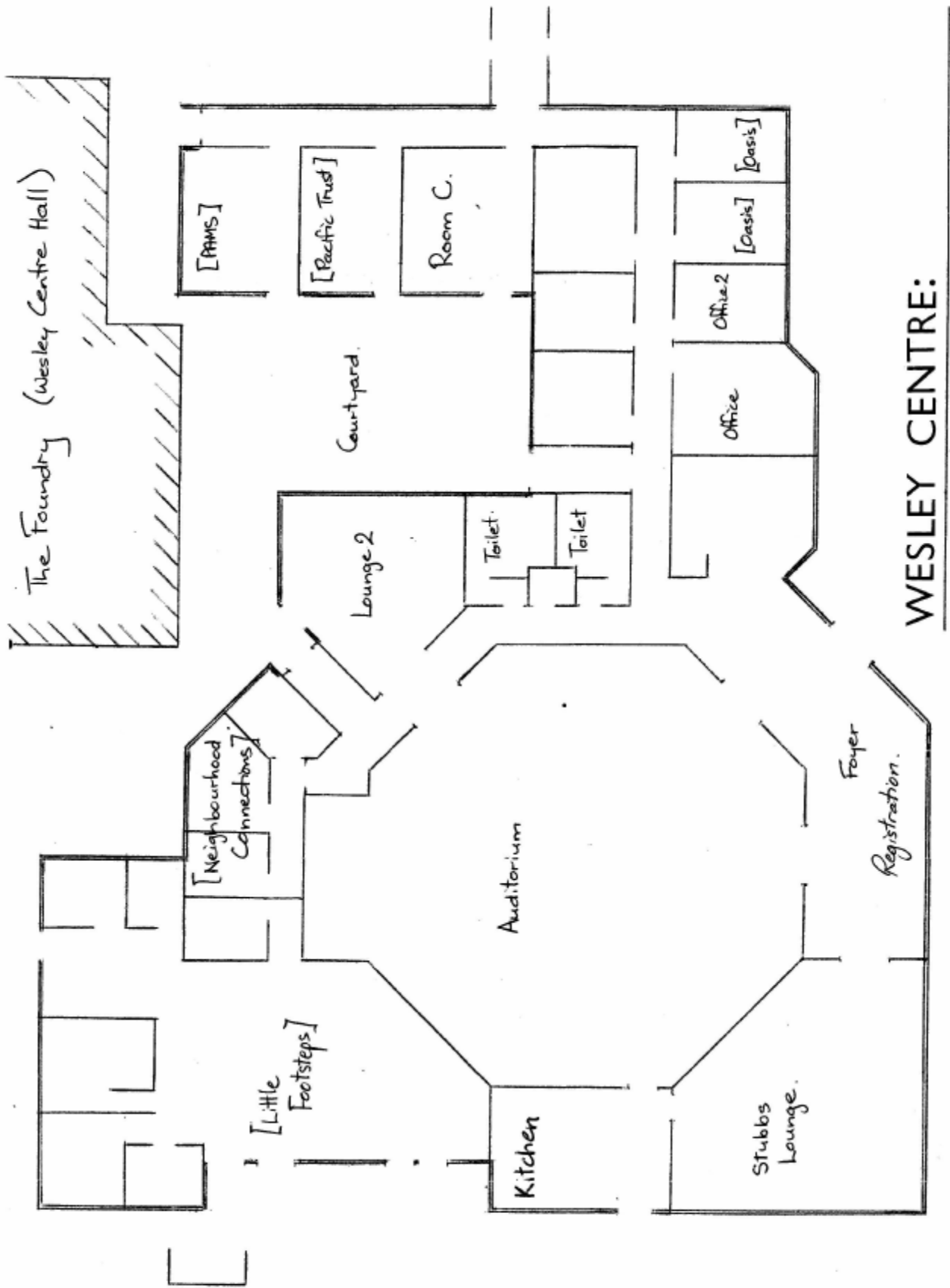

Marlborough Convention Centre



ST ANDREW'S CHURCH (next door to the Wesley Centre)

ST ANDREW'S CHURCH Room Plan, Emergency Exits, Fire Extinguisher Sites - F

Rooms for Committee Meetings (Monday)

- Hall
- Room 4
- Room 5
- Room 6

