

Floorplans

Sketch it on the computer...

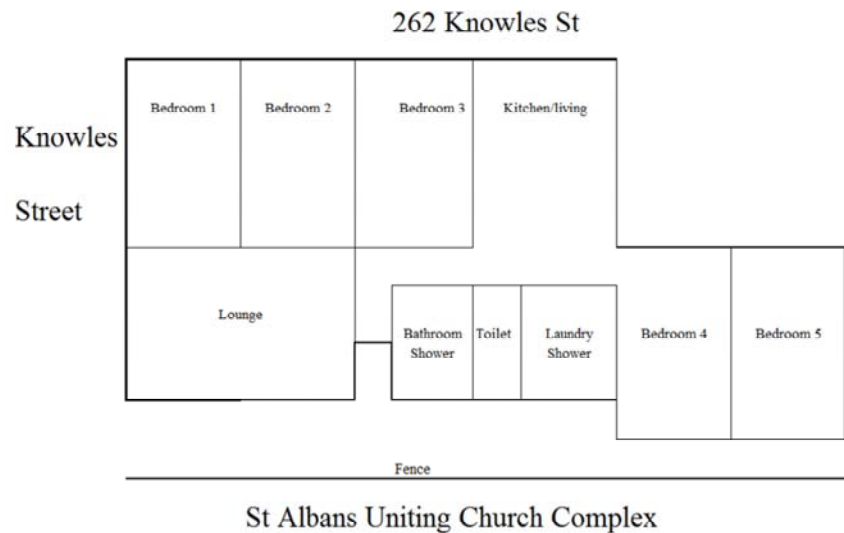

Floor plans don't have to be exact, so long as they will stand the test of time and still make sense.

Room names should make sense, and remember to include where roads are (and garages etc)

Room names should refer to front side, back side, garage side, driveway side. They should refer to things that will have the same longevity as the building!

Don't just number the rooms

Don't name the rooms after a person

Floorplans

Use a building plan

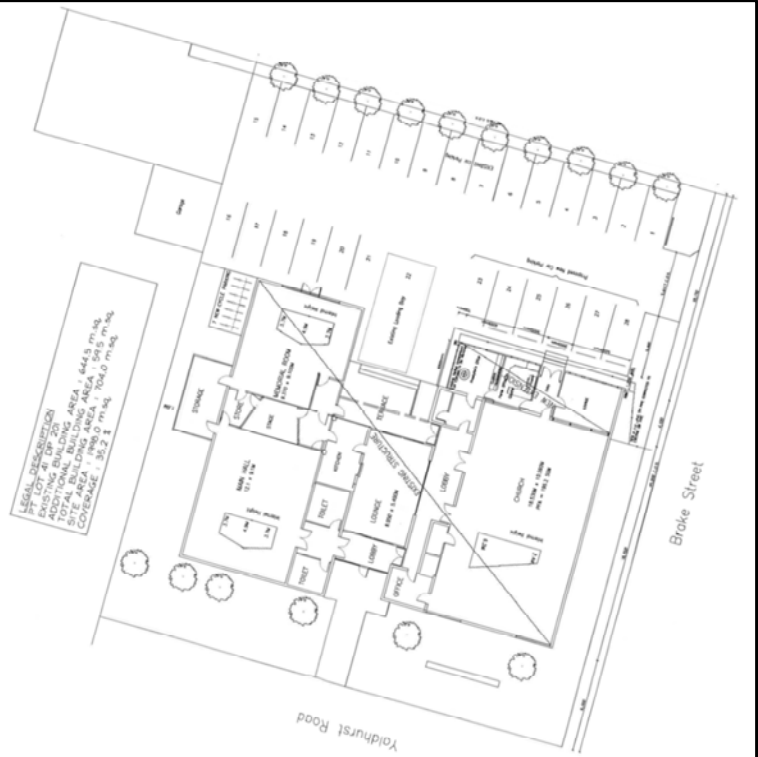

Building plans are the best to use if you can access them

Still check the room names, because if they rooms were originally named after a function (ie children's room), then over time that function may have changed so the plan label will be daft.

Floorplans

Use google maps as the starting footprint.



Or hand sketch it - there are many ways to get a building outline!
(Please note, the bedrooms haven't been well named in this example)

Quick recap –

1. we have stage 1 form– general information about the building and the people that use it, instructions.
2. We have a floor plan
3. The last thing needed to complete our Stage 1 Asbestos Management Plan is our asbestos management statement